

# CAMSHAFT - CHAIN TENSIONER

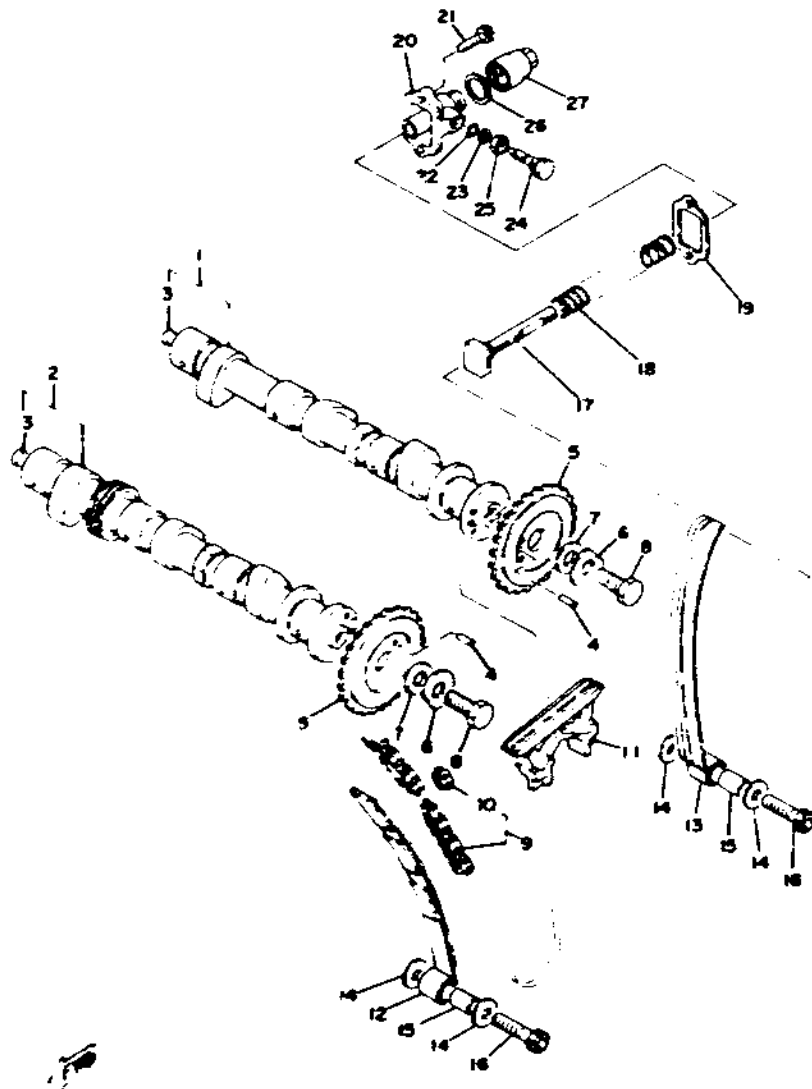

Ref. No.	Part Number	Description	Qty.
1	3J2-12171-00-00	INTAKE CAMSHAFT ASS'Y (3J2-12170-00) .....	1
2	1T5-12181-00-00	EXHAUST CAMSHAFT ASS'Y (1T5-12180-00) .....	1
3	90331-10011-00	PLUG .....	2
4	93604-10010-00	PIN, dowel (4-10) .....	2
5	1J7-12176-01-00	SPROCKET, camshaft .....	2
6	90209-10149-00	WASHER (10.5-28-1.0) .....	2
7	90201-10596-00	WASHER, plate (10.5-22-3.0)...	2
8	97311-10025-00	BOLT, hexagon .....	2
9	94500-02124-00	CHAIN (BF05M-124L) .....	1
10	94600-02001-00	JOINT, chain .....	1
11	1J7-12241-00-00	GUIDE, stopper 2 .....	1
12	1J7-12251-01-00	DAMPER, chain 1 (1J7-12251-00)	1
13	1J7-12252-00-00	DAMPER, chain 2 .....	1
14	90201-06066-00	WASHER, plate (6.5-20-2.0) (101-28323-00) .....	4
15	90387-06540-00	COLLAR (6.2-11-16.3) .....	2
16	91316-06035-00	BOLT, hexagon socket head ....	2
17	1J7-12217-00-00	ROD, chain tensioner .....	1
18	90501-16417-00	SPRING, compression .....	1
19	1J7-12213-00-00	GASKET, chain tensioner case ...	1
20	1J7-12212-02-00	CASE, chain tensioner .....	1
21	91316-06020-00	BOLT, hexagon socket head ....	2
22	93210-06001-00	O-RING (1.9-5.8) .....	1
23	92901-06600-00	WASHER, plate .....	1
24	90109-08442-00	BOLT .....	1
25	95301-08700-00	NUT, hexagon .....	1
26	90430-16141-00	GASKET (16.2-20.5-1) .....	1
27	1J7-12215-01-00	CAP, tensioner case .....	1