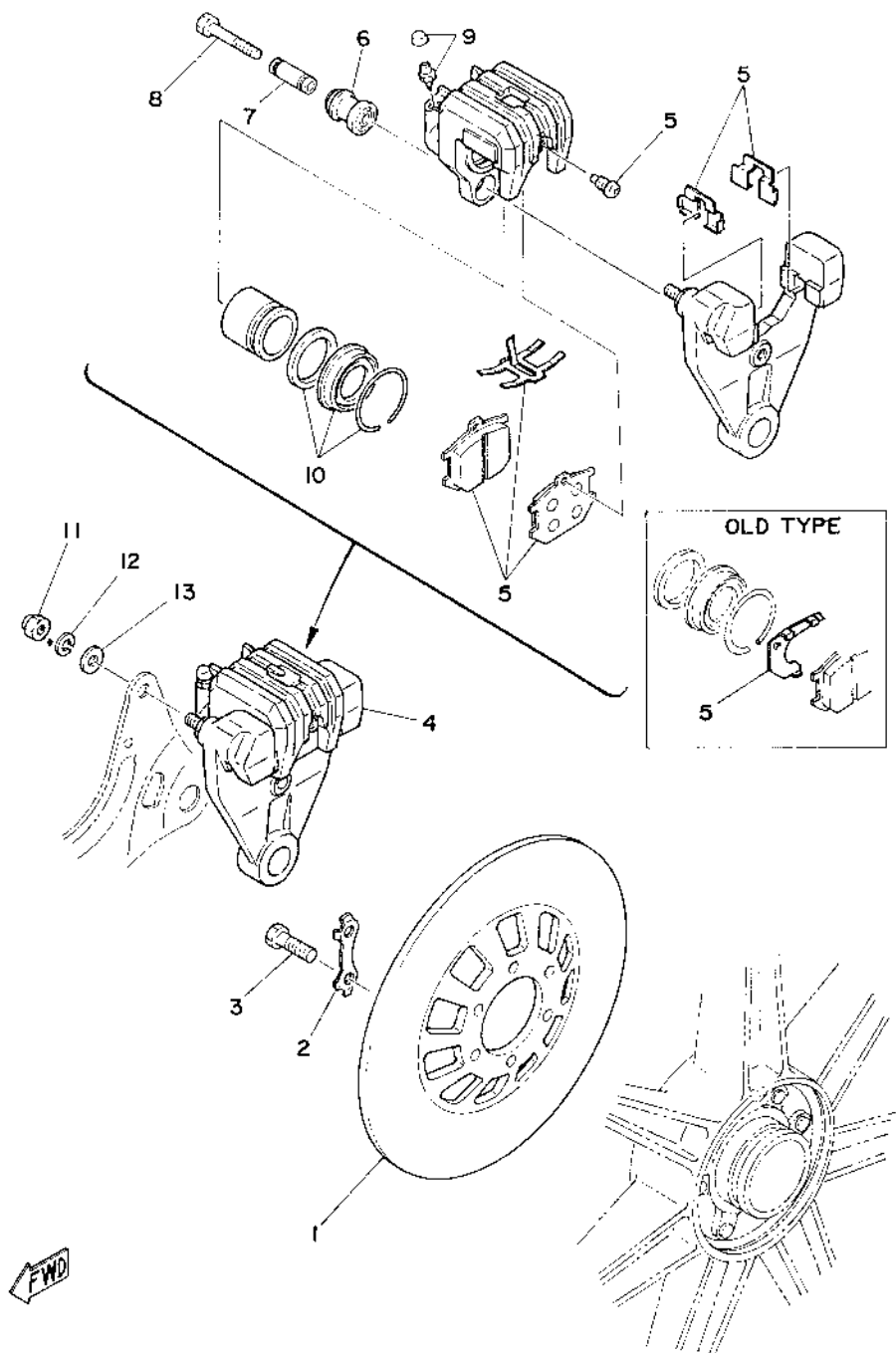

Fig. 39 REAR DISK BRAKE - CALIPER



129

| Ref. No. | Part's No.   | Description             | Q'ty |                 | Remarks |
|----------|--------------|-------------------------|------|-----------------|---------|
|          |              |                         | 7500 | 750 Machine No. |         |
| 39- 1    | 1J3-25831-50 | DISK, rear brake        | 1    | 1               |         |
| 2        | 1J3-25834-00 | WASHER, lock            | 3    |                 | ↕       |
|          | 1J3-25834-01 | WASHER, lock            | 3    | 3               |         |
| 3        | 90101-08307  | BOLT, hexagon           | 6    | 6               |         |
| 4        | 1J7-25810-51 | CALIPER ASS'Y, rear     | 1    |                 | ↕       |
|          | 1J7-25810-52 | CALIPER ASS'Y, rear     | 1    | 1               |         |
| 5        | 1J3-20000-61 | . CALIPER PAD KIT       | 1    |                 | ↕       |
|          | 1J3-20000-62 | . CALIPER PAD KIT       | 1    |                 | ↕       |
|          | 1J3-20000-63 | . CALIPER PAD KIT       | 1    | 1               |         |
| 6        | 1J3-25917-00 | . BUSHING, boot         | 1    | 1               |         |
| 7        | 1J3-25843-00 | . SLEEVE                | 1    | 1               |         |
| 8        | 90105-08092  | . BOLT, support         | 1    | 1               |         |
| 9        | 1J3-20000-30 | . SCREW, bleed with cap | 1    | 1               |         |
| 10       | 1J3-20000-20 | . CALIPER SEAL KIT      | 1    | 1               |         |
| 11       | 95303-08800  | NUT, crown              | 1    | 1               |         |
| 12       | 92903-08100  | WASHER, spring          | 1    | 1               |         |
| 13       | 92903-08600  | WASHER, plate           | 1    | 1               |         |